



PLANNING COMMITTEE

7th September 2017

(Agenda Item 7)

PLANNING APPLICATION ITEMS

LOCATION PLANS

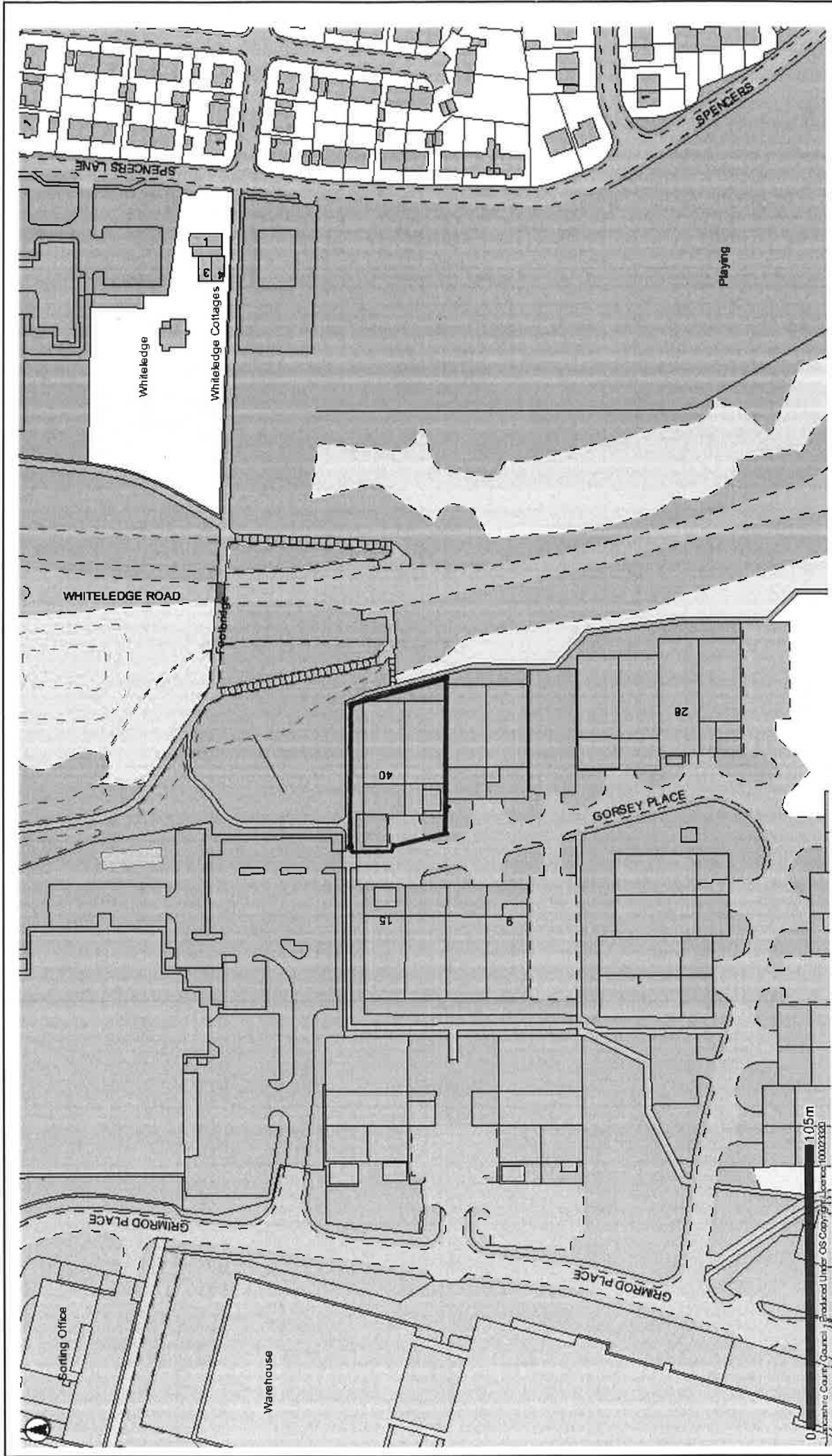

Report No **1** 2017/08/13/WL3 Units 38 & 40 Gorsey Place Skelmersdale WN8 9UP

This map is reproduced from Ordnance Survey material with the Permission of Ordnance Survey on behalf of the Controller of Her Majesty's Stationery Office (C) Crown Copyright.
 Unauthorised reproduction may lead to prosecution or civil proceedings.
 Lancashire County Council - OS Licence 100023320 (C)
 Centre of map: 348620:405463

Date: 24/08/2017





Report No 2.2017/0196/FUL Land rear of 9-15 Tan House Lane Parbold WN8 7HG

This map is reproduced from Ordnance Survey material with the Permission of Ordnance Survey on behalf of the Controller of Her Majesty's Stationery Office (C) Crown Copyright.
 Unauthorised reproduction may lead to prosecution or civil proceedings.
 Lancashire County Council - OS Licence 100023320 (C)
 Centre of map: 349208 410925

Date: 24/08/2017





Report No 3 2017/0588/FUL Railway Hotel 1 Station Road Parbold WN8 7NU

This map is reproduced from Ordnance Survey material with the Permission of Ordnance Survey on behalf of the Controller of Her Majesty's Stationery Office (C) Crown Copyright. Unauthorised reproduction may lead to prosecution or civil proceedings. Lancashire County Council - OS Licence 100023320 (C) Centre of map: 349079.410718

Date: 24/08/2017



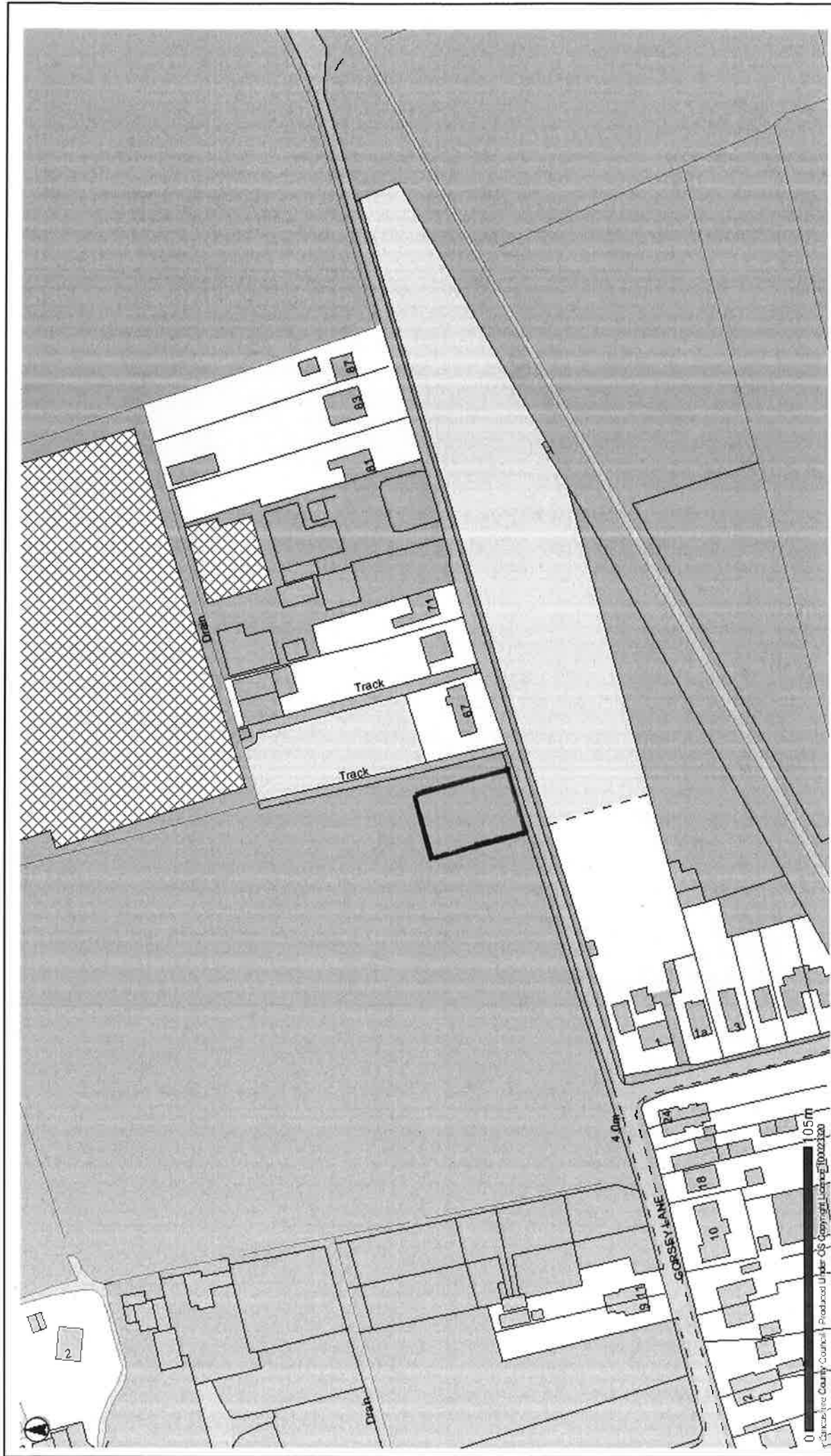

Report No: 4- 2017/0541/FUL Land Adjacent to 67 Gorse Lane, Banks, PR9 8ED.

This map is reproduced from Ordnance Survey material with the Permission of Ordnance Survey on behalf of the Controller of Her Majesty's Stationery Office (C) Crown Copyright. Unauthorised reproduction may lead to prosecution or civil proceedings. Lancashire County Council - OS Licence 100023320 (C) Centre of map: 340086 421234

Date: 24/08/2017





Report No. 5 2017/0251/COU | Knowsley Mews Ormskirk L39 4RB

Date: 24/08/2017

This map is reproduced from Ordnance Survey material with the Permission of Ordnance Survey on behalf of the Controller of Her Majesty's Stationery Office (C) Crown Copyright.
 Unauthorised reproduction may lead to prosecution or civil proceedings.
 Lancashire County Council - OS Licence 100023320 (C)
 Centre of map: 341771.408097

